

MEAN HIGH WATER LINE SURVEY AND PROPOSED EROSION CONTROL LINE FOR OCEAN RIDGE SHORE PROTECTION PROJECT IN THE TOWN OF OCEAN RIDGE PALM BEACH COUNTY, FLORIDA

LENGTH: 137 MILES

SECTIONS 15, 22 AND 27, TOWNSHIP 45 SOUTH, RANGE 43 EAST

STATE OF FLORIDA
COUNTY OF PALM BEACH

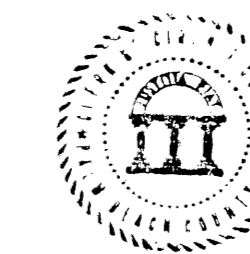

THIS PLAT WAS FILED FOR RECORD AT 11:40 AM, THIS 12th DAY OF September 1997, AND DULY RECORDED IN PLAT BOOK NO. 80 ON PAGES 180 THROUGH 183 DOROTHY H. WILKEN CLERK OF THE CIRCUIT COURT
BY Leigh A. Standley, C.

LEGAL DESCRIPTION OF PROPOSED EROSION CONTROL LINE

COMMENCING AT NATIONAL GEODETIC SURVEY MONUMENT HAULOVER RM-3, HAVING COORDINATES OF NORTHING 804982.38 FEET AND EASTING 813043.35 AS REFERENCED TO THE FLORIDA STATE PLANE COORDINATE SYSTEM, EAST ZONE, NORTH AMERICAN DATUM 1927, PROCEED S 42° 51' 58" W A DISTANCE OF 394.31 FEET TO A POINT WHERE THE NORTH BOUNDARY LINE OF OCEAN INLET PARK (AS DESCRIBED IN PALM BEACH COUNTY OFFICIAL RECORDS BOOK 132, PAGE 612 AND AS SHOWN ON A SURVEY BY PALM BEACH COUNTY, DATED 12-19-88), INTERSECTS THE MEAN HIGH WATER LINE OF THE ATLANTIC OCEAN AS LOCATED ON 11-30-93 (ELEVATION 1.85 FEET NATIONAL GEODETIC VERTICAL DATUM OF 1929), SAID POINT HAVING COORDINATES OF NORTHING 804693.37 FEET AND EASTING 812775.11 FEET (NAD 1927), AND BEING THE POINT OF BEGINNING OF THE FOLLOWING DESCRIBED LINE: THENCE CONTINUE ALONG THE MEAN HIGH WATER LINE THE FOLLOWING COURSES AND DISTANCES: S 19° 30' 37" W A DISTANCE OF 231.15 FEET; THENCE S 17° 39' 50" W A DISTANCE OF 289.98 FEET; THENCE S 09° 44' 37" W A DISTANCE OF 301.11 FEET; THENCE S 06° 43' 56" W A DISTANCE OF 352.13 FEET; THENCE S 10° 39' 59" W A DISTANCE OF 274.19 FEET; THENCE S 14° 14' 49" W A DISTANCE OF 255.22 FEET; THENCE S 17° 32' 01" W A DISTANCE OF 209.12 FEET; THENCE S 15° 03' 26" W A DISTANCE OF 56.66 FEET; THENCE S 17° 32' 44" W A DISTANCE OF 243.99 FEET; THENCE S 14° 29' 03" W A DISTANCE OF 249.39 FEET; THENCE S 11° 25' 30" W A DISTANCE OF 229.47 FEET; THENCE S 24° 00' 04" W A DISTANCE OF 63.81 FEET; THENCE S 12° 58' 44" W A DISTANCE OF 261.71 FEET; THENCE S 10° 45' 13" W A DISTANCE OF 329.89 FEET; THENCE S 16° 03' 07" W A DISTANCE OF 274.25 FEET; THENCE S 20° 34' 17" W A DISTANCE OF 151.80 FEET; THENCE S 12° 34' 50" W A DISTANCE OF 239.03 FEET; THENCE S 02° 39' 07" W A DISTANCE OF 253.71 FEET; THENCE S 25° 36' 02" W A DISTANCE OF 36.88 FEET; THENCE S 12° 52' 47" W A DISTANCE OF 114.19 FEET; THENCE S 10° 05' 34" W A DISTANCE OF 290.94 FEET; THENCE S 05° 29' 09" W A DISTANCE OF 264.46 FEET; THENCE S 07° 04' 43" W A DISTANCE OF 258.91 FEET; THENCE S 03° 55' 12" W A DISTANCE OF 245.52 FEET; THENCE S 19° 12' 55" W A DISTANCE OF 78.94 FEET; THENCE S 14° 20' 51" W A DISTANCE OF 244.67 FEET; THENCE S 03° 56' 20" W A DISTANCE OF 258.92 FEET; THENCE S 03° 21' 31" W A DISTANCE OF 296.50 FEET; THENCE S 00° 35' 06" W A DISTANCE OF 236.07 FEET; THENCE S 42° 49' 32" W A DISTANCE OF 35.97 FEET; THENCE S 03° 25' 23" W A DISTANCE OF 265.29 FEET; THENCE S 03° 11' 36" W A DISTANCE OF 154.92 FEET; THENCE S 42° 05' 28" W A DISTANCE OF 20.48 FEET; THENCE S 15° 13' 26" W A DISTANCE OF 177.04 FEET; THENCE S 00° 00' 06" E A DISTANCE OF 253.36 FEET; THENCE S 28° 40' 25" W A DISTANCE OF 42.06 FEET TO THE POINT OF TERMINATION, HAVING COORDINATES OF NORTHING 797332.68 AND EASTING 811386.00 (NAD 1927). THENCE CONTINUE ALONG THE SHORELINE THE FOLLOWING COURSES TO DEPARTMENT OF NATURAL RESOURCES MONUMENT G-03: S 12° 51' 05" W A DISTANCE OF 168.64 FEET; THENCE S 02° 14' 15" E A DISTANCE OF 174.42 FEET; THENCE S 31° 54' 16" W A DISTANCE OF 33.11 FEET; THENCE S 10° 45' 47" W OF 430.74 FEET; THENCE S 35° 38' 05" W A DISTANCE OF 13.73 FEET; THENCE S 06° 46' 22" W A DISTANCE OF 238.62 FEET; THENCE DEPARTING SAID SHORELINE, S 09° 19' 30" W A DISTANCE OF 2199.83 FEET TO SAID MONUMENT G-03, HAVING COORDINATES OF NORTHING 794123.82 AND EASTING 810864.78 IN THE FLORIDA STATE PLANE COORDINATE SYSTEM, EAST ZONE, NORTH AMERICAN DATUM 1927.

APPROVALS

STATE OF FLORIDA
DEPARTMENT OF ENVIRONMENTAL PROTECTION

KNOW ALL PERSONS BY THESE PRESENTS: THAT THE CHIEF OF THE BUREAU OF SURVEY AND MAPPING OF THE DIVISION OF STATE LANDS, DEPARTMENT OF ENVIRONMENTAL PROTECTION OF THE STATE OF FLORIDA HEREBY APPROVES THIS PLAT.
DATED AT THIS 12 DAY OF September, 1997.

TERRY E. WILKINSON, CHIEF
BUREAU OF SURVEY AND MAPPING

CERTIFICATE OF ACCEPTANCE AND RECORDING OF COUNTY CLERK

ACCEPTED FOR FILE AND RECORDED IN THE PUBLIC RECORDS OF PALM BEACH COUNTY, FLORIDA, THIS 12th DAY OF September, 1997, IN PLAT BOOK NO. 80, PAGES 180-183, PURSUANT TO THE PROVISIONS OF CHAPTER 161.181, FLORIDA STATUTES.

Leigh A. Standley
CLERK OF THE COURT

CERTIFICATE OF APPROVAL OF OCEAN RIDGE RESTORATION PROJECT EROSION CONTROL LINE

THIS EROSION CONTROL LINE PLAT WAS APPROVED BY THE BOARD OF COUNTY COMMISSIONERS OF PALM BEACH COUNTY, FLORIDA AT ITS MEETING ON September 2, 1997, PURSUANT TO THE PROVISIONS OF CHAPTER 161.161, FLORIDA STATUTES.

ATTEST
Willa Oswalt / CLERK
BY *Willa Oswalt*

Paul J. ...
CHAIRMAN
PALM BEACH COUNTY COMMISSION

TABLE OF COORDINATES

DESCRIPTION	NORTHING	EASTING	DESCRIPTION	NORTHING	EASTING
T-152	804513.340	812580.590	18	800806.367	811817.496
R-153	803198.910	812244.860	19	800552.925	811805.757
R-154	802205.480	812039.670	20	800519.670	811789.822
R-155	801186.460	811800.120	21	800408.351	811764.368
R-156	799877.960	811555.480	22	800121.917	811713.383
R-157	798884.285	811414.391	23	799858.664	811688.100
R-158	798177.160	811393.370	24	799601.728	811656.195
R-159	797487.193	811298.900	25	799356.780	811639.410
R-160	796306.075	811124.024	26	799082.240	811613.430
			27	799045.200	811552.800
1 P.O.B.	804693.373	812775.107	28	798786.890	811555.090
2	804475.500	812697.910	29	798490.900	811517.720
3	804199.190	812609.920	30	798254.840	811515.310
4	803902.420	812558.960	31	798228.460	811490.850
5	803552.720	812517.680	32	797963.640	811475.010
6	803283.270	812466.930	33	797808.960	811466.380
7	803035.900	812404.120	34	797793.760	811452.660
8	802836.494	812341.119	35	797622.940	811406.170
9	802781.780	812326.400	36	797369.580	811406.180
10	802549.139	812252.845	37 P.O.T.	797332.680	811386.000
11	802307.671	812190.469			
12	802082.748	812145.014			
13	802024.457	812119.060			
14	801759.433	812060.282			
15	801445.335	811998.729			
16	801181.777	811922.897			
17	801039.661	811869.560			

REVISED ADDED ANNOTATIONS AND NOTES PER FDEP 6-23-97
REVISED ADDED EROSION CONTROL LINE FOR MAY '78 1-28-97
REVISED NEW OWNER NAMES AND PARCEL 23A 1-19-96
REVISED LENGTH OF EROSION CONTROL LINE AND P.O.B. 2-6-95
REVISED TITLE PER D.N.R. REQUIREMENTS 5-6-94
REVISED TO CORRESPOND WITH DESCRIPTION 4-11-94
REVISED TO REFLECT EROSION CONTROL LINE 2-17-94
REVISED TITLE TO EROSION CONTROL LINE 2-4-94

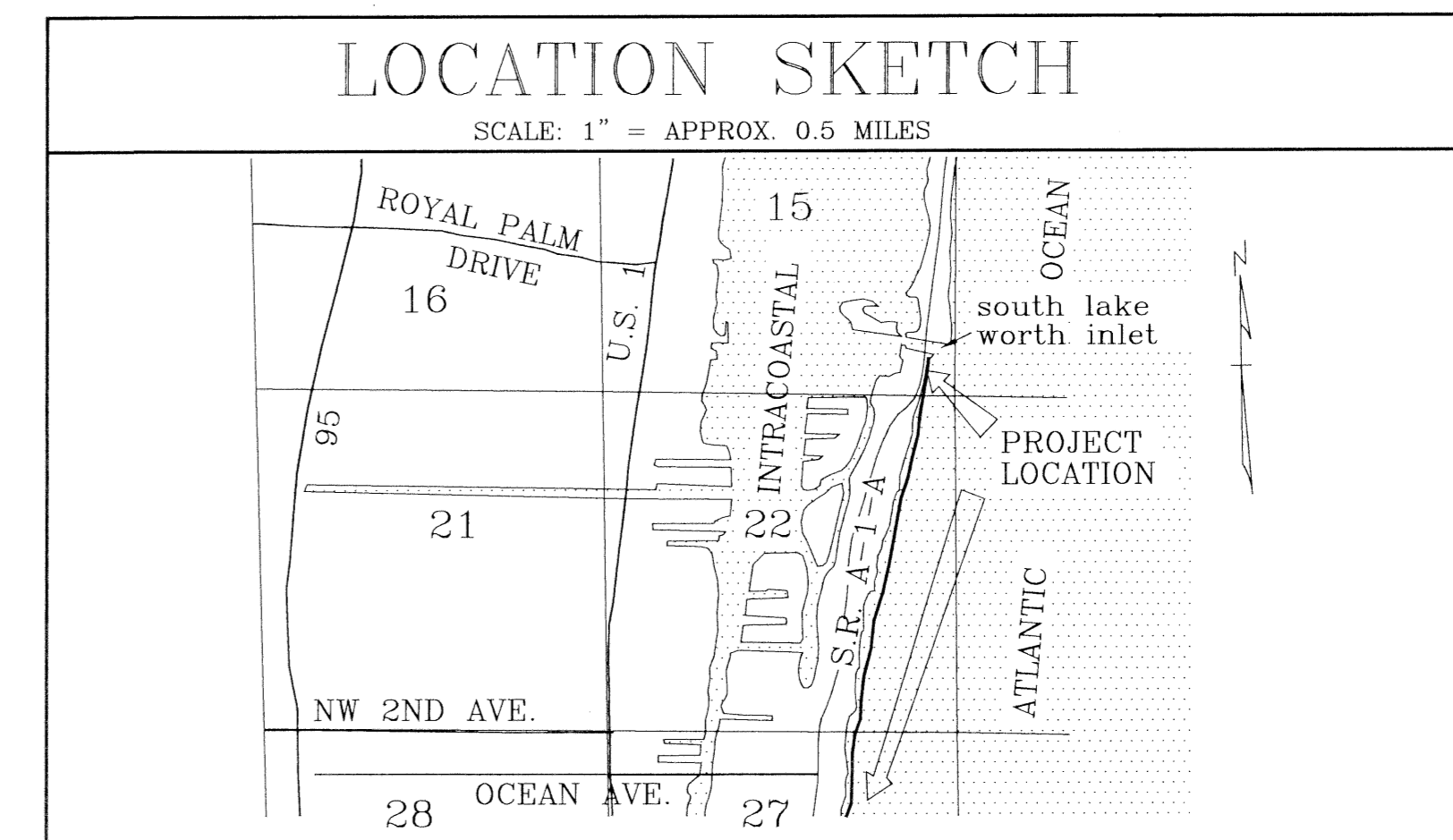

* THIS SURVEY FURNISHES DATA FOR CANCELLATION OF THE NORTHERLY 1.37 MILES OF THE ORIGINAL OCEAN RIDGE/BRINY BREEZES EROSION CONTROL LINE (APPROVED MAY 14, 1982).

LAND SURVEYOR CERTIFICATE

I, JOHN R. MORGAN II, LICENSED TO ENGAGE IN THE PRACTICE OF LAND SURVEYING UNDER THE LAWS OF THE STATE OF FLORIDA, COMMISSIONED BY PALM BEACH COUNTY TO PERFORM THE SURVEY DEPICTED HEREON, DO HEREBY CERTIFY THAT THIS SURVEY COMPLIES WITH AND MEETS THE MINIMUM TECHNICAL STANDARDS FOR LAND SURVEYING, AS SET FORTH BY THE FLORIDA BOARD OF PROFESSIONAL SURVEYORS AND MAPPERS, IN ACCORDANCE WITH CHAPTER 61G17-6, F.A.C. AND CHAPTER 472.07 F.S. I FURTHER CERTIFY THAT THIS SURVEY CONFORMS WITH APPROPRIATE PRINCIPLES SET FORTH PURSUANT TO CHAPTER 161.141 - 161.211 F.S. AND THAT THE MEAN HIGH WATER LINE SURVEY DEPICTED HEREON COMPLIES WITH CHAPTER 177, PART II, FLORIDA STATUTES AND CHAPTER 18-5 FLORIDA ADMINISTRATIVE CODE AND IS RECORDED IN THE PUBLIC REPOSITORY OF THE FLORIDA DEPARTMENT OF ENVIRONMENTAL PROTECTION, MEAN HIGH WATER SURVEY FILE 1091.

MORGAN & EKLAND, INC. (I.B. 4298)

John R. Morgan II
JOHN R. MORGAN II, PSM
FLORIDA REGISTERED SURVEYOR AND MAPPER
CERTIFICATE NUMBER 3520
8745 U.S. HIGHWAY No. 1
P.O. BOX 1420
WABASSO, FLORIDA 32970

6/25/97
DATE

PREPARED BY
MORGAN & EKLAND, INC.

PROFESSIONAL SURVEY CONSULTANTS

8745 U.S. HIGHWAY No. 1
P.O. BOX 1420
WABASSO, FLORIDA 32970
PHONE: (561) 388-5364
FAX: (561) 388-3165

1500 S.E. 3RD COURT
SUITE 203
DEERFIELD BEACH, FL 33441
PHONE: (305) 421-6882
FAX: (305) 421-0451

BOOK 80
PAGE 180
FLOOD MAP #
ZONING
SE
TOWNSHIP OF OCEAN RIDGE
PALM BEACH COUNTY